



IMPORTANT!

Please read before unpacking your Guillotine.

You have just received the highest quality Guillotine. With the correct care, it will last many years and possibly a lifetime

Please read and understand before using your Durston Guillotine. If you are uncertain about any part of these instructions, or you have any concerns, please contact us.

If you have any further queries or questions relating to your Guillotine, please do not hesitate to contact us:

✉ support@durston.com

☎ +44 (0) 1494 535388 / +44 (0) 1494 526777

🌐 www.durston.com

Assembly Instructions

The Guillotine may need to be assembled before use. Please ignore this part of the instructions if your Guillotine is already assembled.

Carefully unpack the Guillotine and discard any packing materials.

Please place the Guillotine on a flat surface and assemble as follows:

1. Attach the Depth Stop to the Guillotine. Undo the two M5x16 Cap Screws from the ruler.
2. Offer up the Depth Stop to the Guillotine.
3. Screw the two M5x16 Cap Screws into the holes and tighten up.
4. Now insert the handle and screw in the M5x25mm screw.

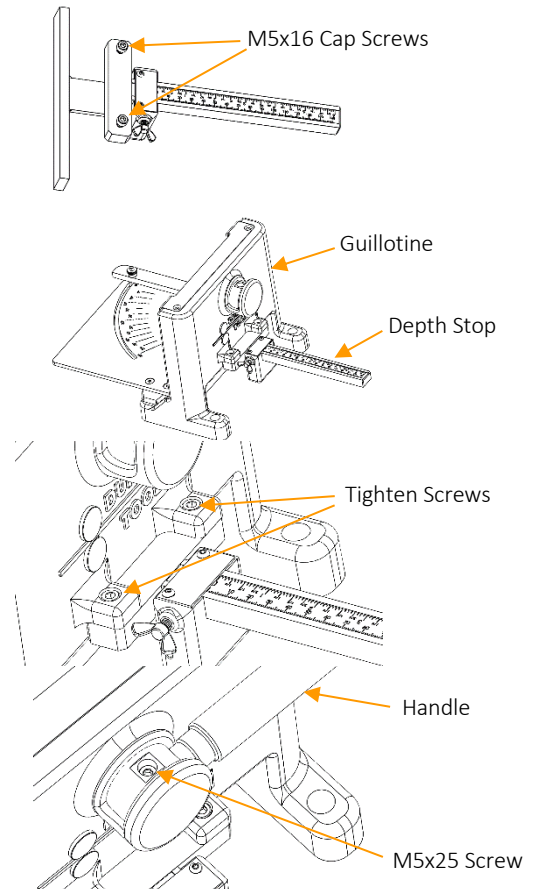

Safety

Place the Guillotine on a secure and non-moveable bench, or substantially built stand and bolt to the surface. There are four bolt holes. Two are visible at the rear of the Guillotine and two are under the main plate.

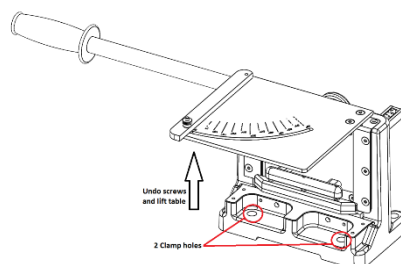

Do not attempt to cut stainless steel, heat treated or hardened materials.

The maximum thickness capacity is 10 gauge in mild steel.

Always wear safety glasses, protective clothing and tie back long hair.

Never cut rusted materials when the blades have lost their sharp edge.

Never cut rusted materials or greasy/oily materials – always clean them first.

Changing the Blades

Tools required to change the blade on the Durston Guillotine:

- Metric Allen Keys
- Clean Cloth
- Light Oil
- Feeler Gauges

To change the blade on the side:

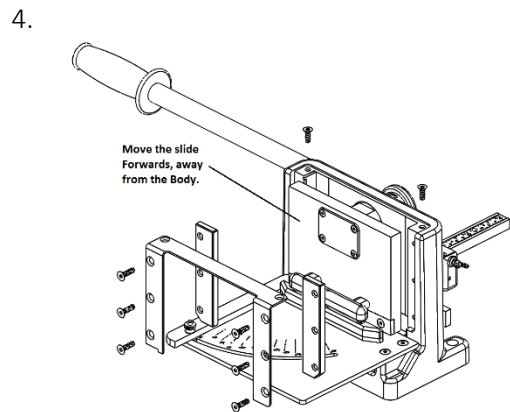
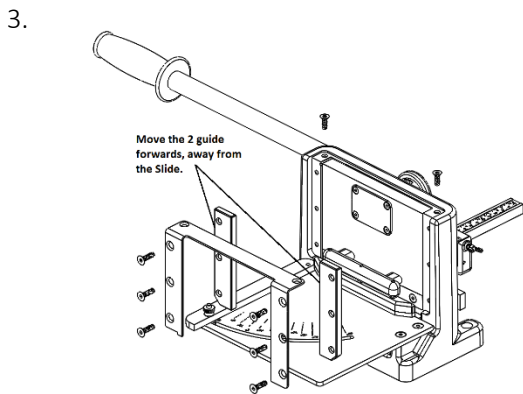
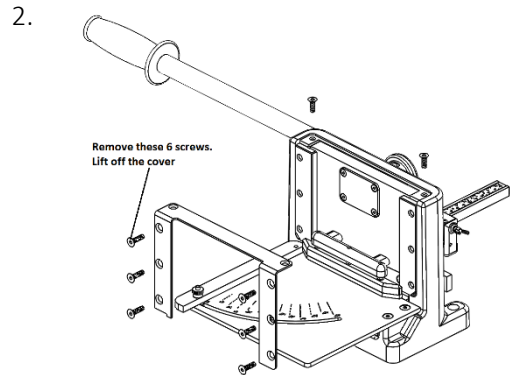
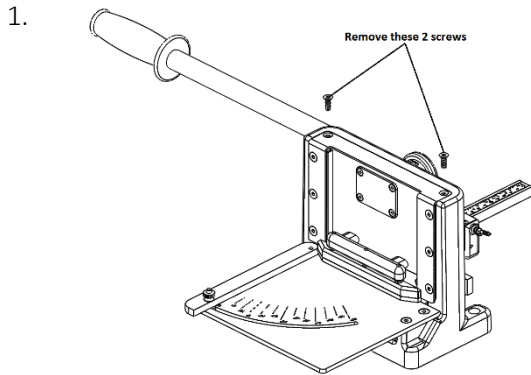

5. Take the side plate and place it on the bench as shown

6.

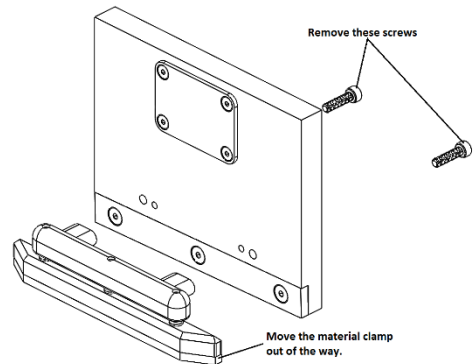
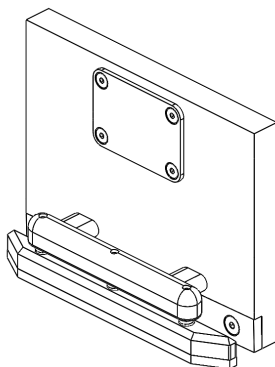

7.

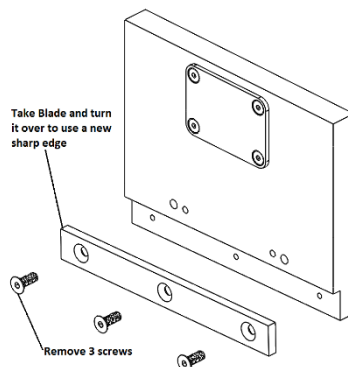

To change the bottom blade:

It is best to change the bottom blade at the same time as you change the blade on the Slide whilst it is out of the Guillotine.

8. Remove the Depth Stop, the Guillotine should look like this. 9.

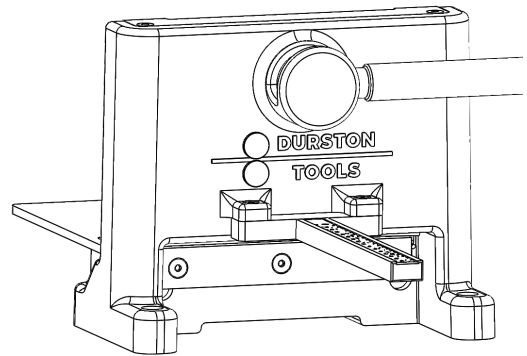
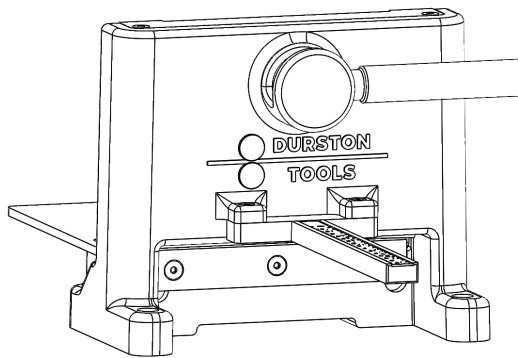

Re-assembly and adjustment.

Clean all parts and apply a light film of oil to all moving parts.

The gap between the blades needs to be adjusted to give 0.05mm (0.002") to 0.10mm (0.004") gap. This will give the optimum performance of the Guillotine.

Remove table to expose adjusting screws:

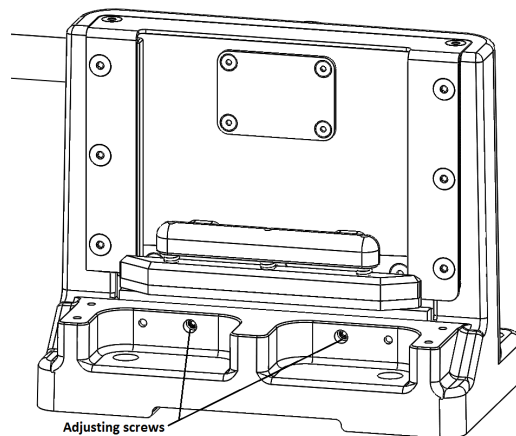

Using Feller Gauges, adjust the screws above to give the correct gap. Check that the Guillotine operates freely, and the blades do not bind.

Reverse this procedure above to re-assemble the Guillotine.

Your Durston Guillotine is now ready for use and should look like this.

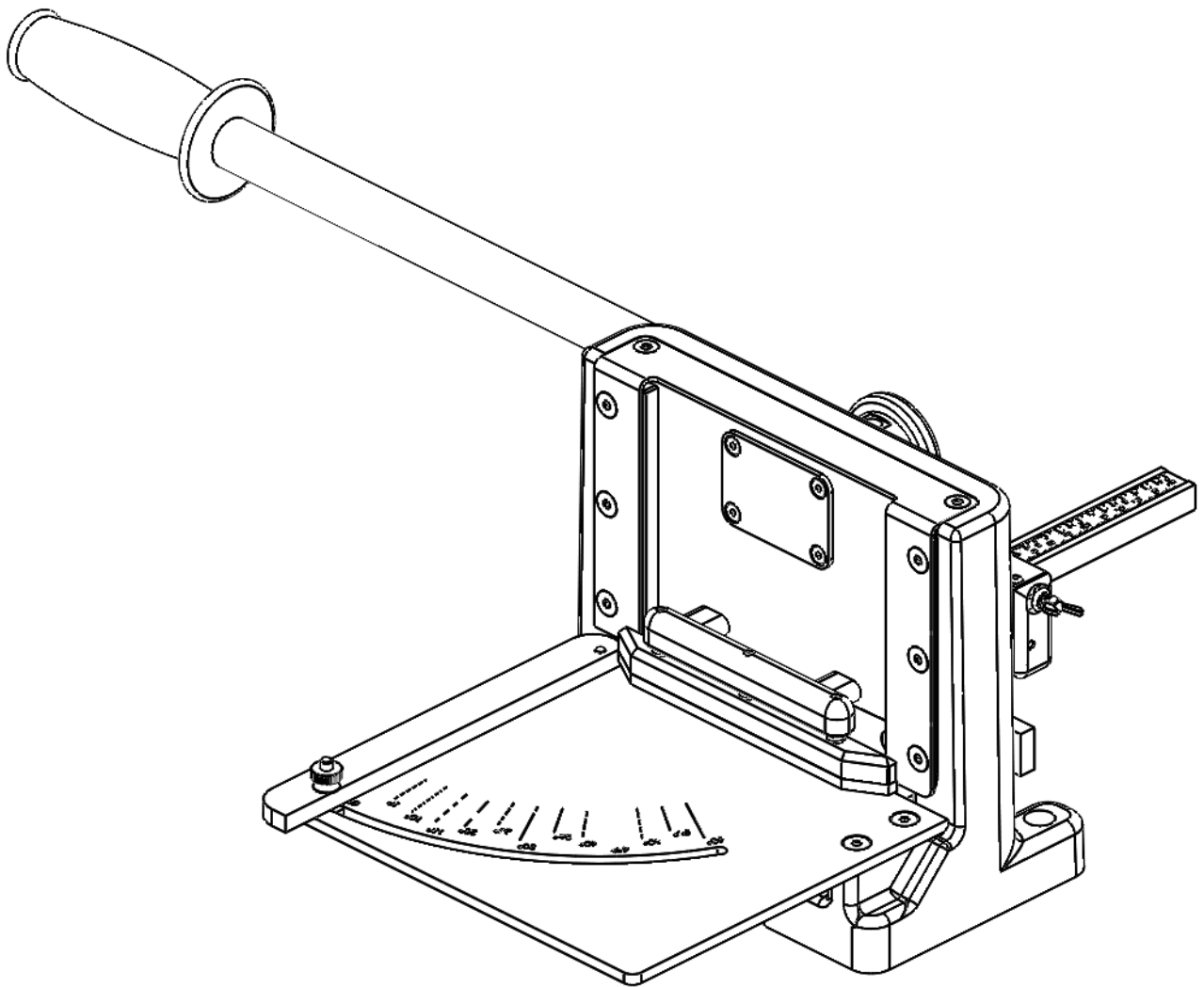



4" Guillotine # 1206

6" Guillotine # 1207

12" Guillotine # 1208